



**DAR**

FOR CHARTER

OCEANCO | 90 M (295.27 FT) | 2018



# DAR

Built by Oceanco, with exterior design by Luiz de Basto Design and interiors by Nuvolari & Lenard/Valentina Zannier Interiors, the 90m yacht **DAR** is now exclusively offered for charter. DAR's layout deviates from contemporary yacht designs. Nearly 3,000 gross tons of volume have been allocated to each feature, providing **ample space**.

DAR can accommodate up to 12 guests in **complete privacy**, thanks to its unique setup. The designers Nuvolari & Lenard/Valentina Zannier Interiors has crafted welcoming interiors that seamlessly connect to the yacht's highly versatile exteriors. Her impressive features include **a complete owner's deck**, with a **private salon and jacuzzi**, a **wellness area**, and an **impressive beach club**.



# KEY FEATURES

## COMPLETE OWNER'S DECK

with fully private salon and jacuzzi  
pool deck forward, isolated from  
cameras in total privacy

## BEACH CLUB

prized space onboard for  
sunbath, cocktails, and  
much more

## 7 CABINS

for 12 guests: 1 x Owner,  
2 x VIPs , 4 x Double

## ELEVATOR

Six person elevator  
serving all guest decks







# KEY FEATURES

## WELLNESS AREA

Hammam, sauna,  
massage/beauty salon

## POOL

with fresh water,  
counter current

## GYM

fully equipped and with floor to  
ceiling windows

## WATER TOYS

Extensive list  
of water-sports



The entire vessel exudes a **seamless elegance**. Glistening white balconies and walkways, along with the roofline, sheer line, transom, and bridge, create an illusion of perpetual motion, especially accentuated by the sharply angular bow.

White streaks appear suspended in time against the backdrop of the deep black hull and reflective mirror-glass superstructure, adding an extra layer of **captivating allure** to the scene.



***DAR*** LOOKS LIKE  
NO OTHER YACHT.











# OWNER'S DECK

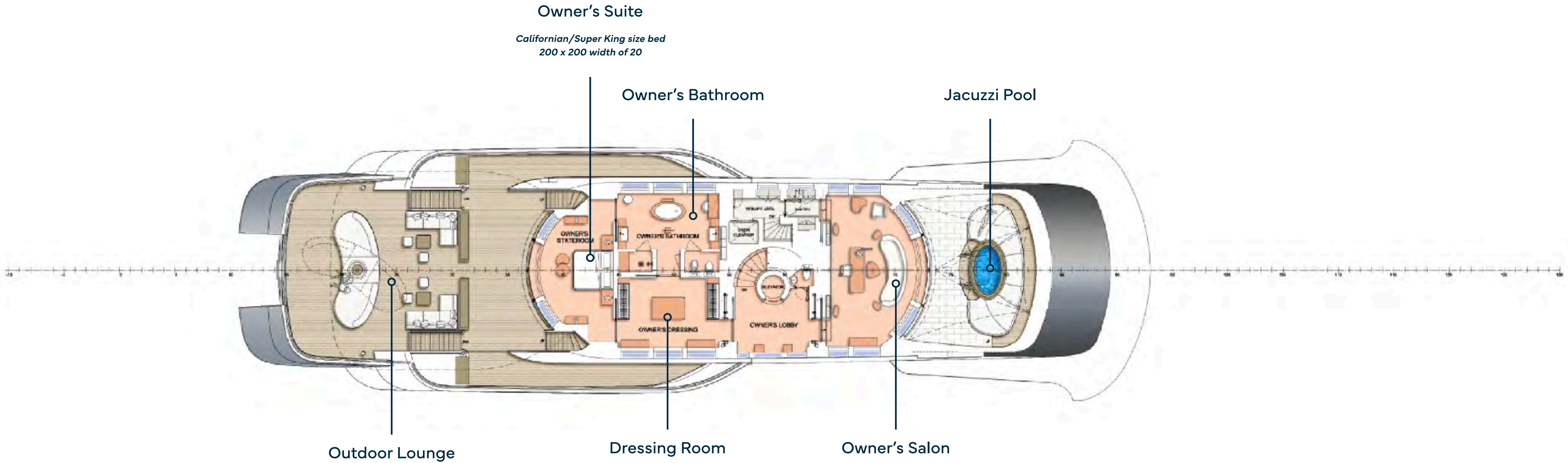





# JACUZZI POOL

Forward is a jacuzzi pool with a shower – a space that cannot be overlooked.





JACUZZI POOL





JACUZZI POOL





**JACUZZI POOL**





JACUZZI POOL





**OWNER'S SALON**





**DRESSING ROOM**



# OWNER'S BATHROOM

The Owner's deck features a spa tub within the luxurious grand en suite, offering **ocean views** while you indulge in a bath.

Additionally, there is a separate terrace at the front, complete with a jacuzzi, providing **complete privacy**.





**OWNER'S BATHROOM**





**OWNER'S SUITE**





# OUTDOOR LOUNGE

An entire deck is **dedicated to the owner**. The 135-square-metre apartment has private access to a teak-top deck. It could also be set up for **entertaining, sport, or even as an outdoor cinema**.





**OUTDOOR LOUNGE**





**OUTDOOR LOUNGE**







**OUTDOOR LOUNGE**





**OUTDOOR LOUNGE**







# POOL

Immerse yourself in the inviting **6-metre pool**, where you can swim effortlessly against the gentle countercurrent.

Twin oversized umbrellas gracefully pivot to your desired angle, providing the perfect shade for your comfort. Unwind on the plush sunbeds or recline on the serpentine side sofas, creating a **haven of relaxation and leisure**.







POOL





**POOL**





**OUTDOOR DINING**





**OUTDOOR DINING**



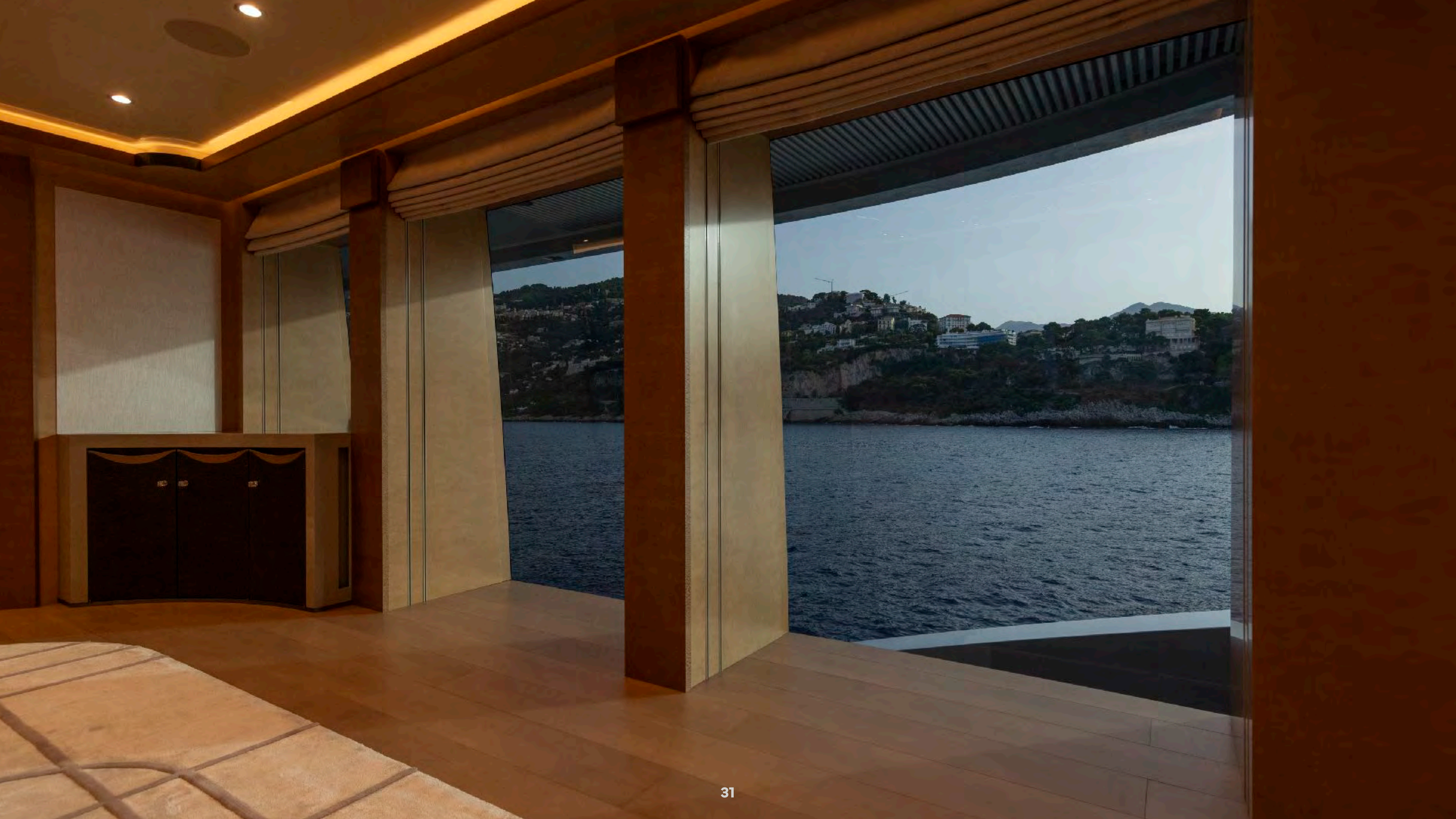





**BAR AREA**





**BAR AREA**









TV SALON







TV SALON



# MAIN DECK

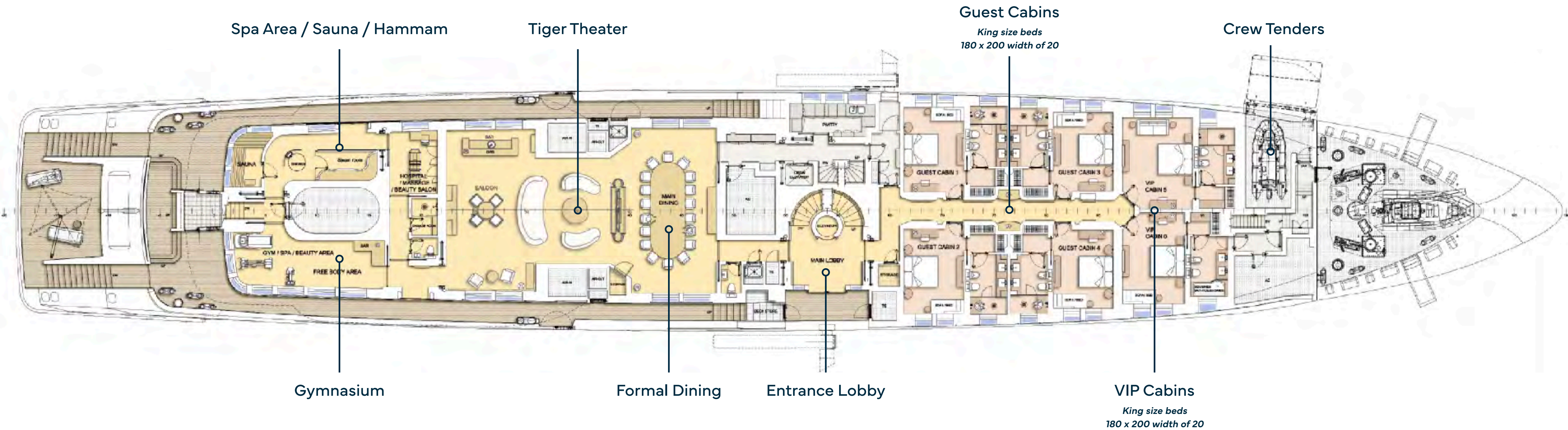

*\*Please note there are 6 sofa beds (1 in each Guest Cabin) that can be set up as a small single bed for children under 10 years old.  
Bed size: 70 x 190 cm.*



# TIGER THEATER

The main deck tiger theater offers a **large lounge** with bar, games area and TV screen.







**TIGER THEATER**





**TIGER THEATER**





**TIGER THEATER**





**FORMAL DINING**





**FORMAL DINING**













## DOUBLE GUEST CABIN

The remaining guest quarters, comprising **two VIP cabins** and **four double cabins**, can be found forward on the main deck.





**BATHROOM**





**DOUBLE GUEST CABIN**





**BATHROOM**





VIP CABIN





VIP CABIN





VIP CABIN





# GYMNASIUM

Step into luxury within the confines of a **70-square-meter studio** that seamlessly blends wellness and opulence.

Enjoy **panoramic sea views** while engaging in a workout session with the state-of-the-art Technogym equipment.





**GYMNASIUM**

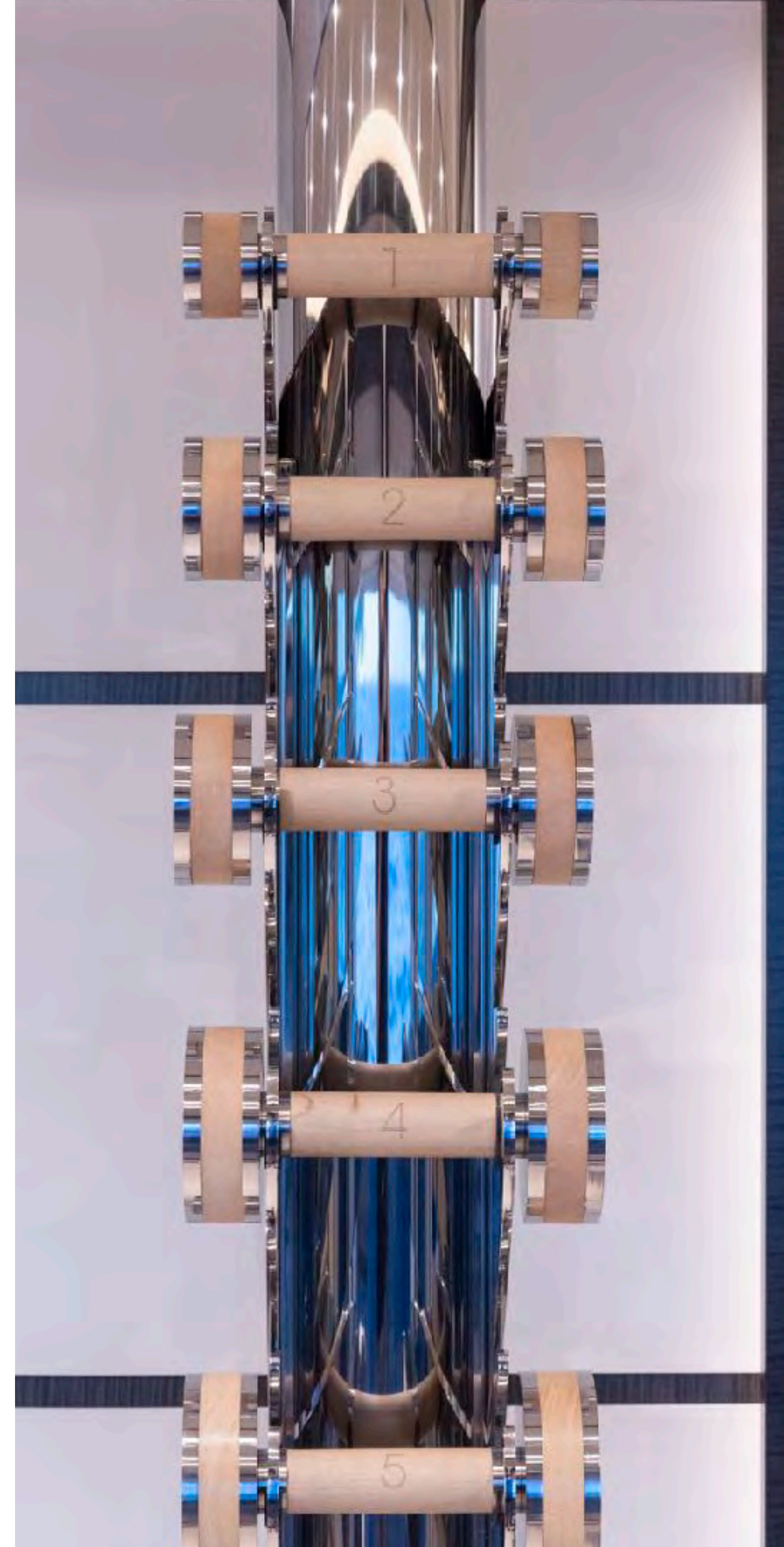





**GYMNASIUM**





**GYMNASIUM**





**GYMNASIUM**



The image shows the interior of a modern wooden sauna. The walls, ceiling, and benches are made of light-colored wood. A large glass window on the right side provides a view of a blue landscape, possibly a lake or sea. The sauna is empty, and the lighting is warm and inviting. A white text box is overlaid on the right side of the image, containing the word "SAUNA" in large, bold, dark blue letters, followed by a descriptive sentence in smaller, dark blue text. The page number "58" is located at the bottom center of the page.

# SAUNA

Unwind and rejuvenate in a blissful retreat designed to restore both body and mind.





**SAUNA**



# HAMMAM

Immerse yourself in a luxurious retreat where a hammam and a walk-in rain shower await, creating a **sanctuary adorned with opulence.**





**HAMMAM**





**HAMMAM**





# MASSAGE BEAUTY SALON

The ambiance is elevated by Prussian blue silk wallpaper adorned with meticulously hand-painted and appliquéd Japanese flowers, creating an **atmosphere of tranquility and sophistication** in the serene beauty salon.



**MASSAGE BEAUTY SALON**





MASSAGE BEAUTY SALON





**MASSAGE BEAUTY SALON**











DAR

BEACH CLUB





**BEACH CLUB**





BEACH CLUB





**BEACH CLUB**



# SEA-LEVEL ENTRANCE

Enjoy a leisurely drink **right at the water's edge** or take a thrilling dive straight into the sea.









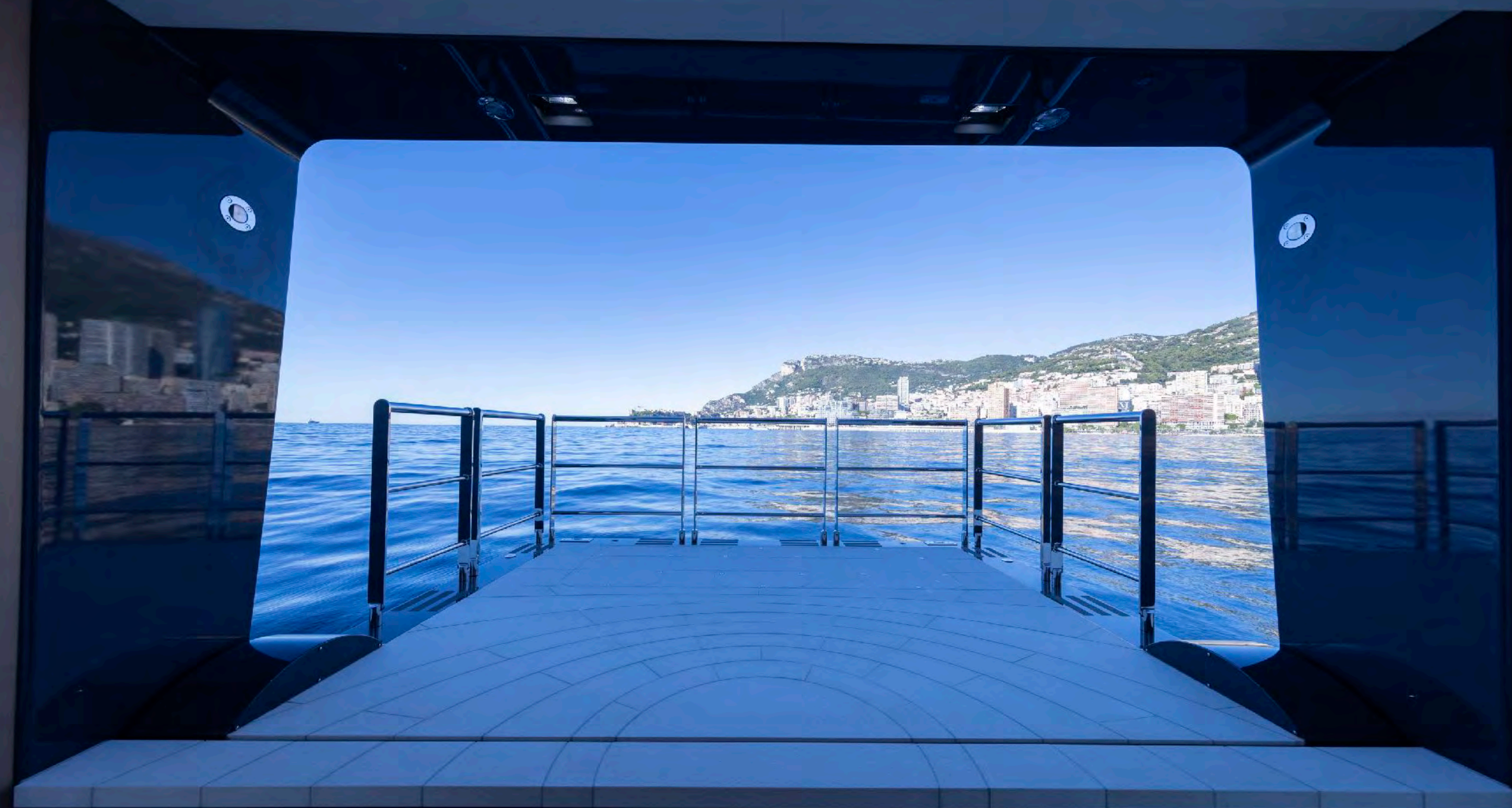















# TENDER GARAGE

A dwelling for the two exceptional 10.5-meter Hodgdon tenders





# TWIN-WIN TENDERS

The two exquisite 10.5-meter Hodgdon tenders epitomize unparalleled excellence.

Both the limousine and open tender showcase a **perfect blend** of **speed, stability,** and **exquisite craftsmanship.**

These tenders stand as a seamless extension of the yacht, embodying the highest standards of quality and luxurious comfort.







# **SPECIFICATION**



## CHARACTERISTICS

<b>NAME:</b>	DAR
<b>BUILDER:</b>	OCEANCO
<b>YEAR BUILT:</b>	2018
<b>TYPE:</b>	DISPLACEMENT MOTOR YACHT
<b>HULL NO.:</b>	Y717
<b>IMO:</b>	1013066
<b>CLASSIFICATION:</b>	LLOYD'S REGISTER
<b>FLAG:</b>	CAYMAN ISLANDS
<b>NAVAL ARCHITECT:</b>	AZURE NAVAL ARCHITECTS B.V.
<b>EXTERIOR DESIGNER:</b>	LUIZ DE BASTO DESIGN
<b>INTERIOR DESIGNER:</b>	NUVOLARI & LENARD VALENTINA ZANNIER INTERIORS (REFIT 2024)
<b>CONSTRUCTION:</b>	STEEL HULL ALUMINIUM SUPERSTRUCTURE TEAK DECKS 2,355
<b>DISPLACEMENT:</b>	1 X FWD DECK - MAX LOAD 3.8T
<b>HELI DECKS:</b>	1 X SUN DECK - MAX LOAD 3.0T

## DIMENSIONS

<b>LENGTH OVERALL:</b>	90.00 M (295'3")
<b>LENGTH WATERLINE:</b>	77.20 M (253'3")
<b>BEAM:</b>	14.20 M (46'7")
<b>MAX DRAFT:</b>	4.05 M (13'3")
<b>GROSS TONNAGE:</b>	2,926
<b>NET TONNAGE:</b>	877







## ACCOMMODATION

---

<b>OWNER:</b>	1 x MASTER CABIN
<b>GUEST:</b>	2 x VIP CABINS 4 x DOUBLE CABINS
<b>CREW:</b>	1 x CAPTAIN CABIN 15 x CREW CABINS
<b>TOTAL:</b>	12 GUESTS IN 7 CABINS
<b>CREW:</b>	30 CREW IN 16 CABINS

## SPEED & RANGE UNDER POWER

---

<b>MAXIMUM SPEED:</b>	20 KNOTS
<b>CRUISING SPEED:</b>	13 KNOTS
<b>FUEL CONSUMPTION:</b>	APPROX. 500 LITRES / HOUR @ 13 KNOTS
<b>RANGE:</b>	5,500NM @ 13 KNOTS



## TENDERS & WATER-SPORTS EQUIPMENT

### TENDERS:

1 x 10.50M HODGDON YACHTS CUSTOM OPEN  
1 x 10.50M HODGDON YACHTS CUSTOM LIMO  
1 x 6.20M COBRA PATRONUS CREW TENDER

### TOYS:

1 x WAVE RUNNER SEADOO GTR STD 230 (2021)  
1 x JETSURF ULTRA SPORT  
1 x FLITEBOARD  
1 x AIRDRONE - DJI INSPIRE 2  
1 x UNDERWATER DRONE - IBUBBLE  
2 x WAVE RUNNER SEADOO GTX LTD 300 (2021)  
2 x JETSKI YAMAHA SUPER JET  
2 x 1 PERSON PRIJON KAYAK  
4 x 2 PERSON BIWOK KAYAK  
4 x SEABOB KAYAGO F5 SR  
5 x GOCYCLE BICYCLE

### DIVING EQUIPMENT:

(RENDEZ-VOUS DIVING ONLY)

BCD: SCUBA PRO  
TANKS: LUXFER - 11LT AND 9LT  
WET SUITS: SCUBA PRO - 3MM AND 5MM  
FINS: MARES  
MASKS: ATOMIC AQUATICS, OCEAN REEF  
BOOTS: SCUBA PRO  
WEIGHTS: SCUBA  
PRO COMPUTER: SUUNTO  
CAMERAS: GO PRO  
ASSORTMENT OF SNORKELLING GEAR: CRESSI,  
OCEAN REEF





## TENDERS & WATER-SPORTS EQUIPMENT

### INFLATABLES:

1 x SAIL BOAT - TIWAL INFLATABLE  
1 x 10 X 6.6M INFLATABLE POOL - FREESTYLE  
1 x ZORB (SPHERE FOR A PERSON TO STEP INTO AND ROLL ON THE WATER)  
1 x 1 PERSON SUP - RED PADDLE  
1 x 3 PERSON SUP - RED PADDLE

### TOWABLES:

1 x WINDSURF - FANATIC  
1 x KITESURF - CABIRINHA  
1 x WATERSKI - JOBE  
1 x KNEEBOARD - JOBE  
1 x WAKEBOARD - JOBE  
TOWABLES JOBE (BANANA, DONUT, BINAR, SONAR)

### ACCESSORIES:

1 x 15M SLIDE - FREESTYLE  
1 x LIQUID FORCE MAGIC CARPET 6' X 18'  
LIFE VESTS AND HELMETS - LIQUID FORCE

## GYM EQUIPMENT

1 x SKILLRUN TECHNOGYM  
1 x BIKE TECHNOGYM  
1 x EXCITE SYNCHRO  
TECHNOGYM WEIGHTS  
YOGA MATS





## ENTERTAINMENT EQUIPMENT

<b>TV ANTENNA:</b>	2 X SEA TEL 6004
<b>GENERAL:</b>	MEDITERRANEAN: SKY UK, SKY ITALY CARIBBEAN: I DIRECT TV LATIN AMERICA DISH AIRPLAY, APPLE TV, NETFLIX, AMAZON PRIME, DISNEY, PARAMOUNT, SPOTIFY X-BOX OCULUS YACHTEYE THROUGHOUT THE VESSEL ALL DEVICES INCLUDING LIGHT AND TEMPERATURE ARE I-PAD CONTROLLED BACKGAMMON, CHESS, CARDS, MONOPOLY

## SECURITY & SAFETY EQUIPMENT

<b>SAFETY:</b>	EPIRB SAILOR SE406-11 2 X SART SAILOR 11 9GHZ
<b>SECURITY:</b>	KABA CENTRAL ANTI-INTRUSION SYSTEM 2 X ANTI-PIRACY WATER CANNONS
<b>FIRE FIGHTING:</b>	MONITORING & ALARM SYSTEM CONSILLIUM HI FOG SYSTEM MARIOFF







---

## COMMUNICATION EQUIPMENT

<b>SATCOM:</b>	SAILOR FBB500, FBB150
<b>VHF:</b>	SAILOR 6215, 6222, 2 X 6248
<b>SSB:</b>	SAILOR 6301
<b>INMARSAT C:</b>	2 X SAILOR 6110
<b>IRIDIUM:</b>	2 X SC4000
<b>TELEPHONE EXCHANGE:</b>	AVAYA
<b>INTERCOM:</b>	PA
<b>VSAT:</b>	2 X SEA TEL 5012
<b>INTERNET:</b>	2 X STARLINK MARITIME
<b>GSM 4G/5G:</b>	PEPWAVE

---

## INTERNET PACKAGE

<b>STARLINK MARITIME</b>	50-100 MBPS
<b>VSAT</b>	MIR 8 MBPS CIR 2 MBPS

STARLINK WILL NOT BE PROVIDED IN AREAS WHERE THERE IS NO STARLINK COVERAGE.

COMMUNICATION PACKAGE IS INCLUDED IN THE CHARTER FEE AND WILL NOT BE CHARGED ON THE APA.

### **ON REQUEST:**

THE COST TO UPGRADE TO A HIGHER VSAT SPEED IS ON THE CLIENT'S ACCOUNT.



A luxury yacht is shown on the water at dusk. The yacht is dark and sleek, with a prominent cabin and a radar scanner on top. The water is calm with gentle ripples. In the background, there are dark, silhouetted mountains under a twilight sky. The overall mood is serene and sophisticated.

# CHARTER RATES



# 2024 CHARTER RATES

**HIGH SEASON**  
JULY AND AUGUST

**€1,400,000**

PER WEEK

*PLUS VAT, PLUS COSTS (APA 30%)*

**LOW SEASON**  
ALL OTHER MONTHS

**€1,200,000**

PER WEEK

*PLUS VAT, PLUS COSTS (APA 30%)*

**EVENTS**

**€1,400,000**

PER WEEK

*PLUS VAT, PLUS COSTS (APA 30%)*

*A Security Deposit of €100,000 applicable to all charters*





**DAR**