



DAR

FOR CHARTER

OCEANCO | 90 M (295.27 FT) | 2018

DAR

Built by Oceanco, with exterior design by Luiz de Basto Design and interiors by Nuvolari & Lenard/Valentina Zannier Interiors, the 90m yacht **DAR** is now exclusively offered for charter. DAR's layout deviates from contemporary yacht designs. Nearly 3,000 gross tons of volume have been allocated to each feature, providing **ample space**.

DAR can accommodate up to 12 guests in **complete privacy**, thanks to its unique setup. The designers Nuvolari & Lenard/Valentina Zannier Interiors has crafted welcoming interiors that seamlessly connect to the yacht's highly versatile exteriors. Her impressive features include **a complete owner's deck**, with a **private salon and jacuzzi**, a **wellness area**, and an **impressive beach club**.

KEY FEATURES

COMPLETE OWNER'S DECK

with fully private salon and jacuzzi pool deck forward, isolated from cameras in total privacy

BEACH CLUB

prized space onboard for sunbath, cocktails, and much more

7 CABINS

for 12 guests: 1 x Owner, 2 x VIPs, 4 x Double

ELEVATOR

Six person elevator serving all guest decks



KEY FEATURES

WELLNESS AREA

Hammam, sauna,
massage/beauty salon

POOL

with fresh water,
counter current

GYM

fully equipped and with floor to
ceiling windows

WATER TOYS

Extensive list
of water-sports

The entire vessel exudes a **seamless elegance**. Glistening white balconies and walkways, along with the roofline, sheer line, transom, and bridge, create an illusion of perpetual motion, especially accentuated by the sharply angular bow.

White streaks appear suspended in time against the backdrop of the deep black hull and reflective mirror-glass superstructure, adding an extra layer of **captivating allure** to the scene.



DAR LOOKS LIKE
NO OTHER YACHT.





JACUZZI POOL

Forward is a jacuzzi pool with a shower – a space that cannot be overlooked.



JACUZZI POOL



JACUZZI POOL



JACUZZI POOL



JACUZZI POOL



OWNER'S SALON

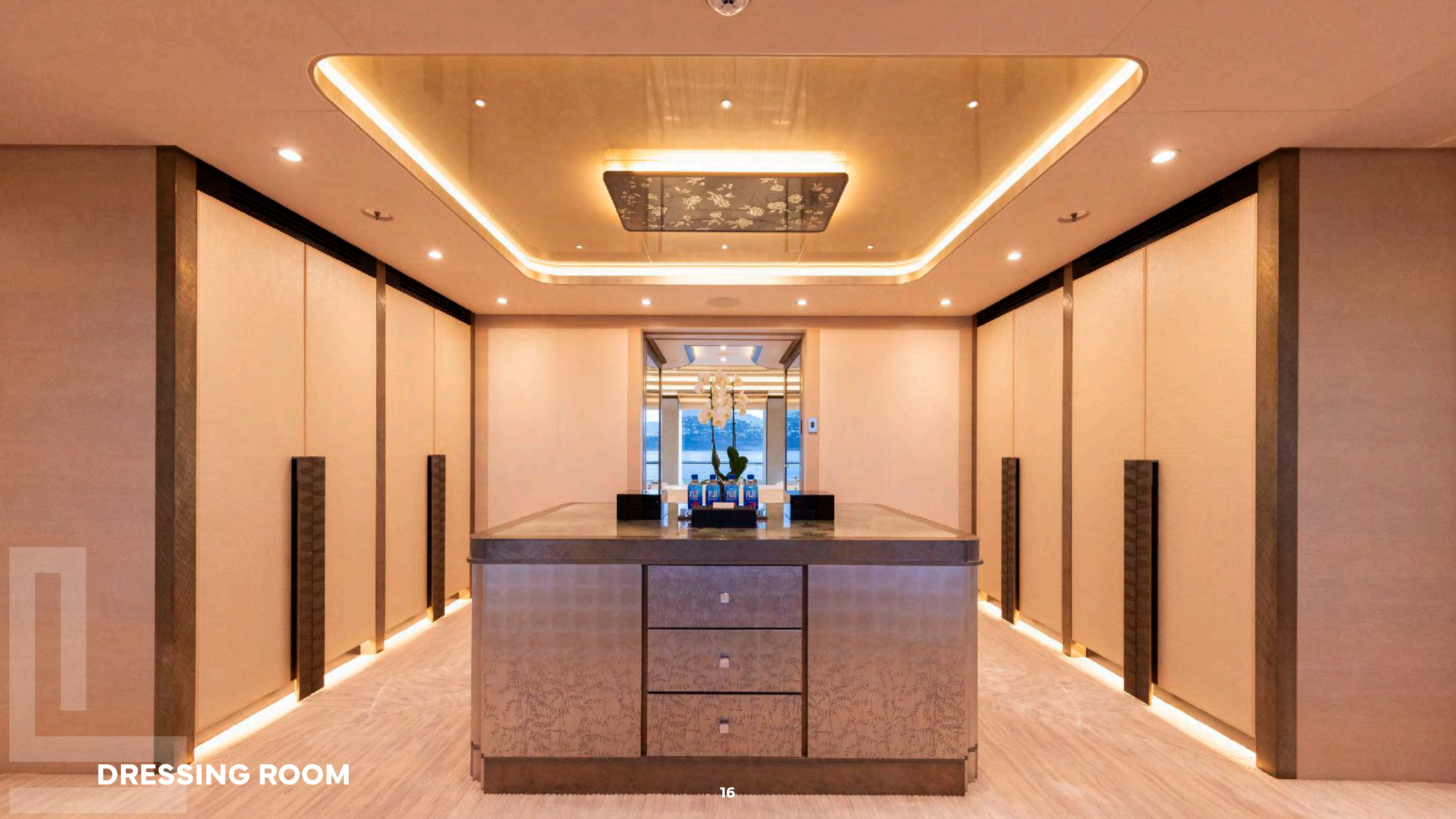

DRESSING ROOM

OWNER'S BATHROOM

The Owner's deck features a spa tub within the luxurious grand en suite, offering **ocean views** while you indulge in a bath.

Additionally, there is a separate terrace at the front, complete with a jacuzzi, providing **complete privacy**.



OWNER'S BATHROOM



OWNER'S SUITE



OUTDOOR LOUNGE

An entire deck is **dedicated to the owner**. The 135-square-metre apartment has private access to a teak-top deck. It could also be set up for **entertaining, sport, or even as an outdoor cinema**.



OUTDOOR LOUNGE



OUTDOOR LOUNGE





OUTDOOR LOUNGE



OUTDOOR LOUNGE

UPPER DECK

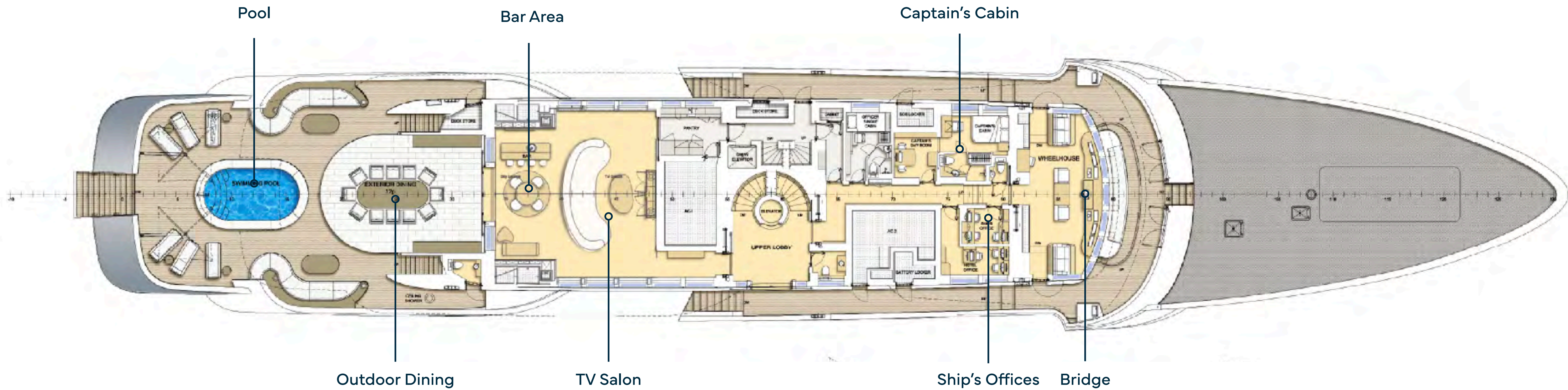

POOL

Immerse yourself in the inviting **6-metre pool**, where you can swim effortlessly against the gentle countercurrent.

Twin oversized umbrellas gracefully pivot to your desired angle, providing the perfect shade for your comfort. Unwind on the plush sunbeds or recline on the serpentine side sofas, creating a **haven of relaxation and leisure**.





POOL



POOL



OUTDOOR DINING



OUTDOOR DINING

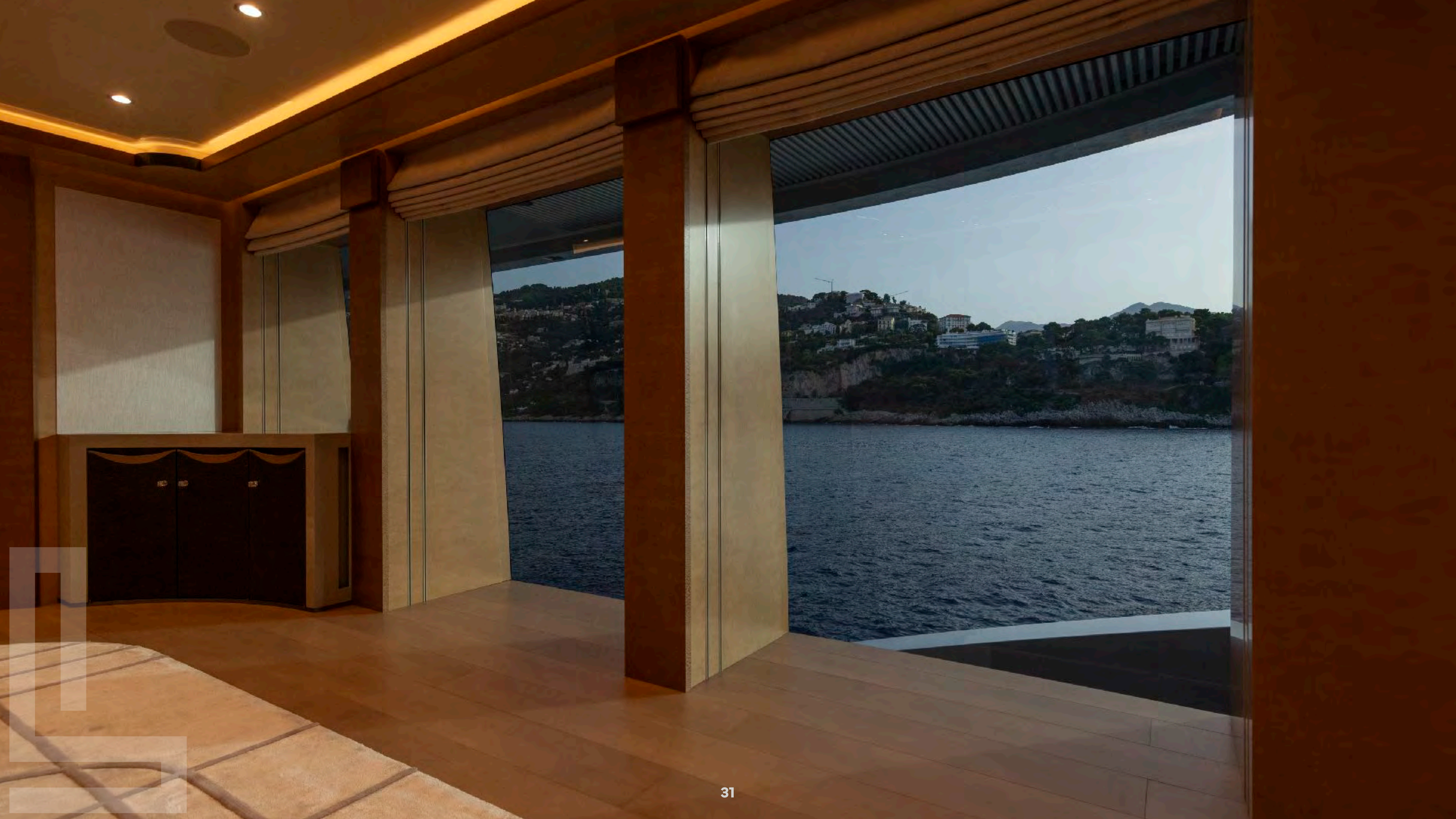



BAR AREA



BAR AREA





TV SALON





TV SALON

MAIN DECK

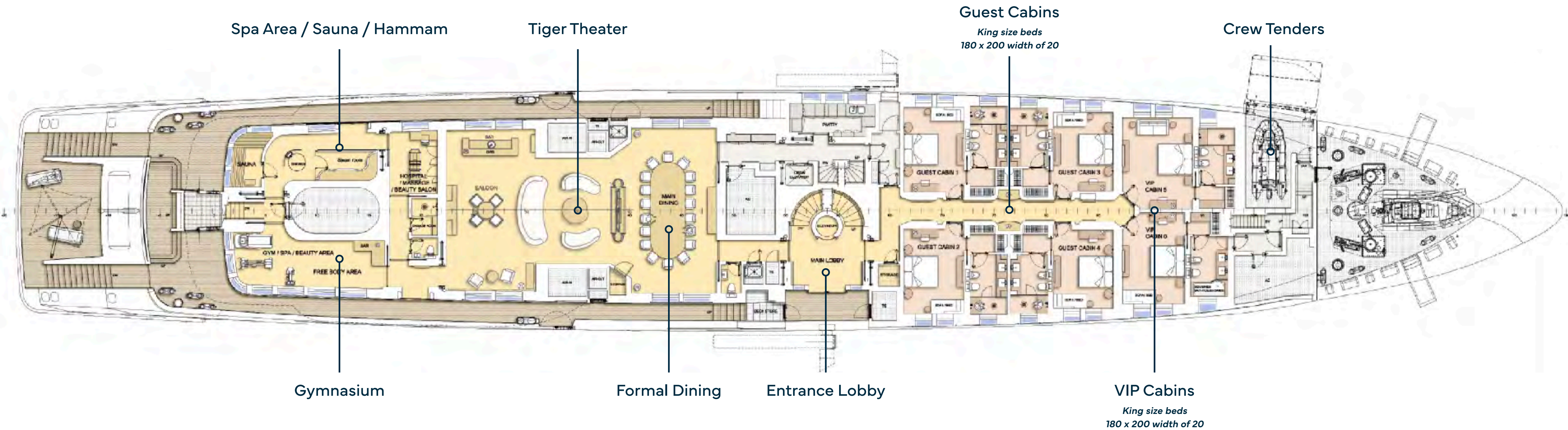

**Please note there are 6 sofa beds (1 in each Guest Cabin) that can be set up as a small single bed for children under 10 years old. Bed size: 70 x 190 cm.*

TIGER THEATER

The main deck tiger theater offers a **large lounge** with bar, games area and TV screen.





TIGER THEATER



TIGER THEATER



TIGER THEATER



FORMAL DINING



FORMAL DINING







DOUBLE GUEST CABIN

The remaining guest quarters, comprising **two VIP cabins** and **four double cabins**, can be found forward on the main deck.



BATHROOM



DOUBLE GUEST CABIN



BATHROOM



VIP CABIN



VIP CABIN



VIP CABIN



GYMNASIUM

Step into luxury within the confines of a **70-square-meter studio** that seamlessly blends wellness and opulence.

Enjoy **panoramic sea views** while engaging in a workout session with the state-of-the-art Technogym equipment.



GYMNASIUM

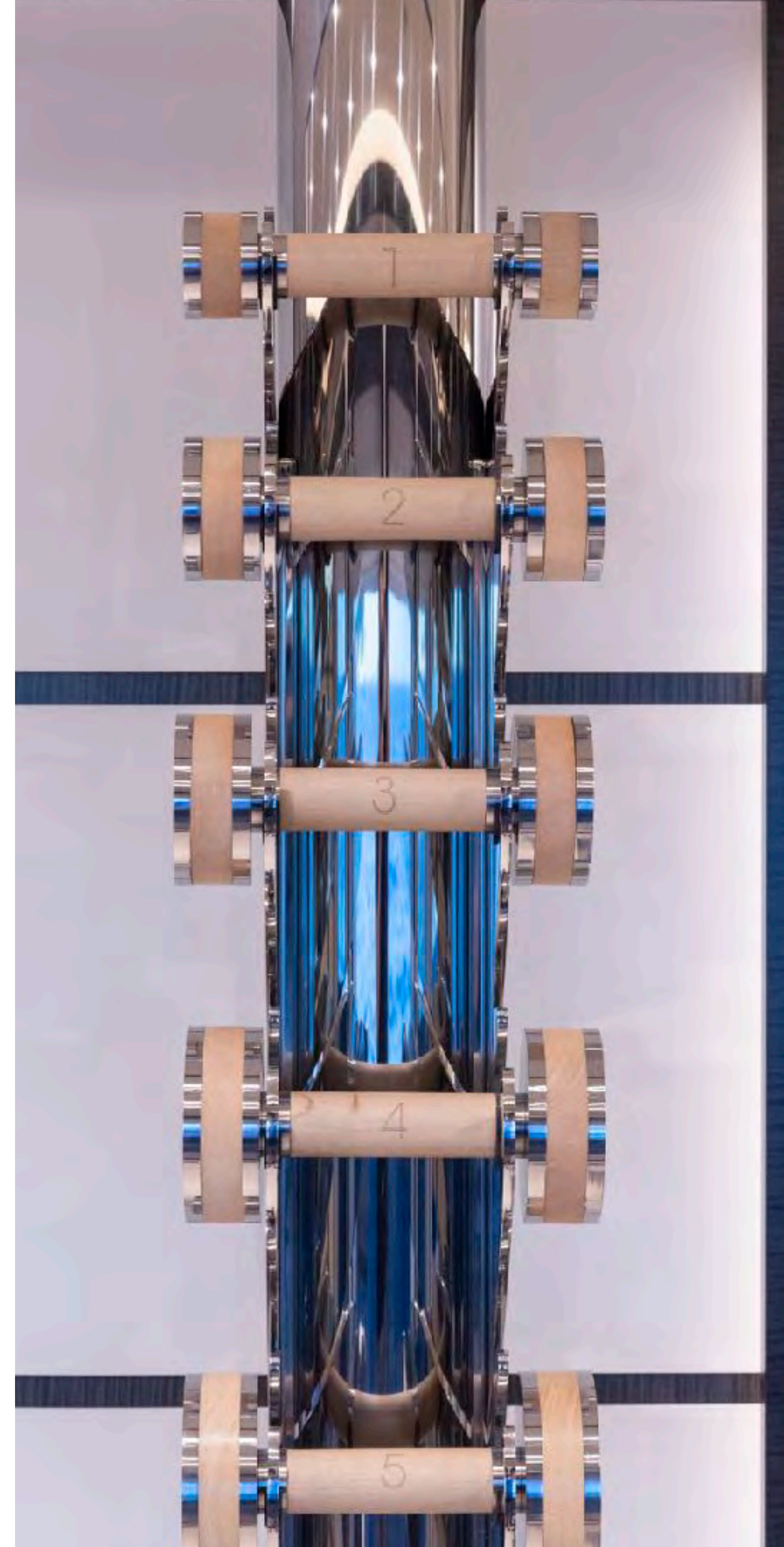



GYMNASIUM



GYMNASIUM



GYMNASIUM

The image shows the interior of a modern wooden sauna. The walls, ceiling, and benches are made of light-colored wood. A window in the center provides a view of the ocean and a coastline. To the left, there is a wooden structure, likely a heater or a storage area for towels. The overall atmosphere is warm and relaxing.

SAUNA

Unwind and rejuvenate in a blissful retreat designed to restore both body and mind.



SAUNA

HAMMAM

Immerse yourself in a luxurious retreat where a hammam and a walk-in rain shower await, creating a **sanctuary adorned with opulence.**



HAMMAM



HAMMAM



MASSAGE BEAUTY SALON

The ambiance is elevated by Prussian blue silk wallpaper adorned with meticulously hand-painted and appliquéd Japanese flowers, creating an **atmosphere of tranquility and sophistication** in the serene beauty salon.

MASSAGE BEAUTY SALON



MASSAGE BEAUTY SALON



MASSAGE BEAUTY SALON



LOWER DECK

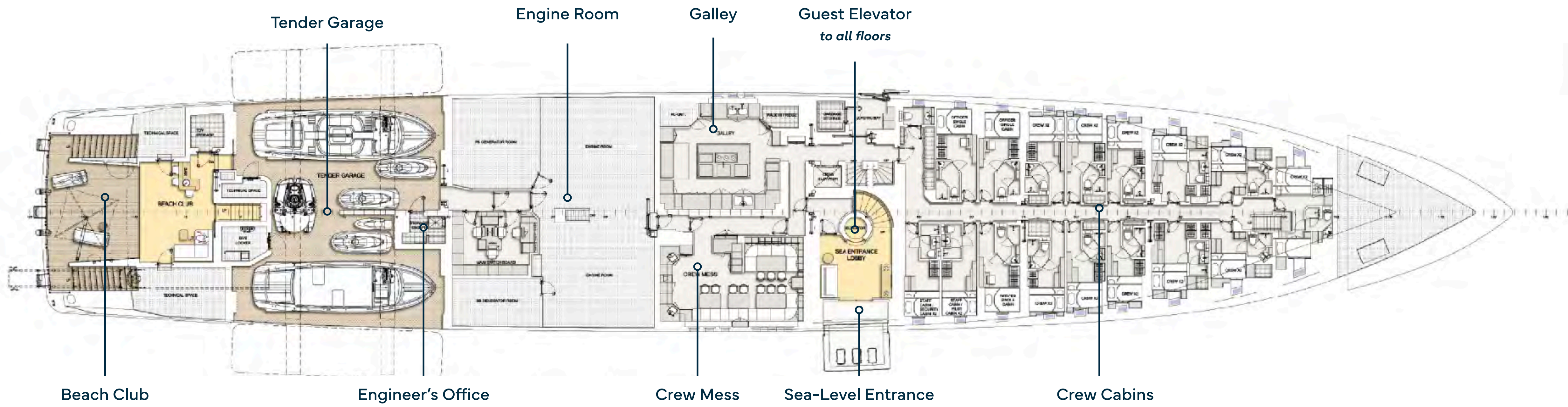



DAR

BEACH CLUB



BEACH CLUB



BEACH CLUB



BEACH CLUB

SEA-LEVEL ENTRANCE

Enjoy a leisurely drink **right at the water's edge** or take a thrilling dive straight into the sea.













TENDER GARAGE

A dwelling for the two exceptional 10.5-meter Hodgdon tenders



TWIN-WIN TENDERS

The two exquisite 10.5-meter Hodgdon tenders epitomize unparalleled excellence.

Both the limousine and open tender showcase a **perfect blend** of **speed, stability,** and **exquisite craftsmanship.**

These tenders stand as a seamless extension of the yacht, embodying the highest standards of quality and luxurious comfort.



The image features a dark blue background with a complex geometric pattern of thin, light blue lines. A prominent bright green vertical line descends from the top center of the frame, ending just above the word 'SPECIFICATION'. The word itself is rendered in a bold, bright green, sans-serif font, centered horizontally. The overall aesthetic is clean, modern, and technical.

SPECIFICATION

CHARACTERISTICS

NAME:	DAR
BUILDER:	OCEANCO
YEAR BUILT:	2018
TYPE:	DISPLACEMENT MOTOR YACHT
HULL NO.:	Y717
IMO:	1013066
CLASSIFICATION:	LLOYD'S REGISTER
FLAG:	CAYMAN ISLANDS
NAVAL ARCHITECT:	AZURE NAVAL ARCHITECTS B.V.
EXTERIOR DESIGNER:	LUIZ DE BASTO DESIGN
INTERIOR DESIGNER:	NUVOLARI & LENARD VALENTINA ZANNIER INTERIORS (REFIT 2024)
CONSTRUCTION:	STEEL HULL ALUMINIUM SUPERSTRUCTURE TEAK DECKS 2,355
DISPLACEMENT:	1 X FWD DECK - MAX LOAD 3.8T
HELI DECKS:	1 X SUN DECK - MAX LOAD 3.0T

DIMENSIONS

LENGTH OVERALL:	90.00 M (295'3")
LENGTH WATERLINE:	77.20 M (253'3")
BEAM:	14.20 M (46'7")
MAX DRAFT:	4.05 M (13'3")
GROSS TONNAGE:	2,926
NET TONNAGE:	877





ACCOMMODATION

OWNER:	1 x MASTER CABIN
GUEST:	2 x VIP CABINS 4 x DOUBLE CABINS
CREW:	1 x CAPTAIN CABIN 15 x CREW CABINS
TOTAL:	12 GUESTS IN 7 CABINS
CREW:	30 CREW IN 16 CABINS

SPEED & RANGE UNDER POWER

MAXIMUM SPEED:	20 KNOTS
CRUISING SPEED:	13 KNOTS
FUEL CONSUMPTION:	APPROX. 500 LITRES / HOUR @ 13 KNOTS
RANGE:	5,500NM @ 13 KNOTS

TENDERS & WATER-SPORTS EQUIPMENT

TENDERS:

1 x 10.50M HODGDON YACHTS CUSTOM OPEN
1 x 10.50M HODGDON YACHTS CUSTOM LIMO
1 x 6.20M COBRA PATRONUS CREW TENDER

TOYS:

1 x WAVE RUNNER SEADOO GTR STD 230 (2021)
1 x JETSURF ULTRA SPORT
1 x FLITEBOARD
1 x AIRDRONE - DJI INSPIRE 2
1 x UNDERWATER DRONE - IBUBBLE
2 x WAVE RUNNER SEADOO GTX LTD 300 (2021)
2 x JETSKI YAMAHA SUPER JET
2 x 1 PERSON PRIJON KAYAK
4 x 2 PERSON BIWOK KAYAK
4 x SEABOB KAYAGO F5 SR
5 x GOCYCLE BICYCLE

DIVING EQUIPMENT:

(RENDEZ-VOUS DIVING ONLY)

BCD: SCUBA PRO
TANKS: LUXFER - 11LT AND 9LT
WET SUITS: SCUBA PRO - 3MM AND 5MM
FINS: MARES
MASKS: ATOMIC AQUATICS, OCEAN REEF
BOOTS: SCUBA PRO
WEIGHTS: SCUBA
PRO COMPUTER: SUUNTO
CAMERAS: GO PRO
ASSORTMENT OF SNORKELLING GEAR: CRESSI,
OCEAN REEF



TENDERS & WATER-SPORTS EQUIPMENT

INFLATABLES:

1 x SAIL BOAT - TIWAL INFLATABLE
1 x 10 X 6.6M INFLATABLE POOL - FREESTYLE
1 x ZORB (SPHERE FOR A PERSON TO STEP INTO AND ROLL ON THE WATER)
1 x 1 PERSON SUP - RED PADDLE
1 x 3 PERSON SUP - RED PADDLE

TOWABLES:

1 x WINDSURF - FANATIC
1 x KITESURF - CABIRINHA
1 x WATERSKI - JOBE
1 x KNEEBOARD - JOBE
1 x WAKEBOARD - JOBE
TOWABLES JOBE (BANANA, DONUT, BINAR, SONAR)

ACCESSORIES:

1 x 15M SLIDE - FREESTYLE
1 x LIQUID FORCE MAGIC CARPET 6' X 18'
LIFE VESTS AND HELMETS - LIQUID FORCE

GYM EQUIPMENT

1 x SKILLRUN TECHNOGYM
1 x BIKE TECHNOGYM
1 x EXCITE SYNCHRO
TECHNOGYM WEIGHTS
YOGA MATS



ENTERTAINMENT EQUIPMENT

TV ANTENNA:	2 X SEA TEL 6004
GENERAL:	MEDITERRANEAN: SKY UK, SKY ITALY CARIBBEAN: I DIRECT TV LATIN AMERICA DISH AIRPLAY, APPLE TV, NETFLIX, AMAZON PRIME, DISNEY, PARAMOUNT, SPOTIFY X-BOX OCULUS YACHTEYE THROUGHOUT THE VESSEL ALL DEVICES INCLUDING LIGHT AND TEMPERATURE ARE I-PAD CONTROLLED BACKGAMMON, CHESS, CARDS, MONOPOLY

SECURITY & SAFETY EQUIPMENT

SAFETY:	EPIRB SAILOR SE406-11 2 X SART SAILOR 11 9GHZ
SECURITY:	KABA CENTRAL ANTI-INTRUSION SYSTEM 2 X ANTI-PIRACY WATER CANNONS
FIRE FIGHTING:	MONITORING & ALARM SYSTEM CONSILLIUM HI FOG SYSTEM MARIOFF





COMMUNICATION EQUIPMENT

SATCOM:	SAILOR FBB500, FBB150
VHF:	SAILOR 6215, 6222, 2 X 6248
SSB:	SAILOR 6301
INMARSAT C:	2 X SAILOR 6110
IRIDIUM:	2 X SC4000
TELEPHONE EXCHANGE:	AVAYA
INTERCOM:	PA
VSAT:	2 X SEA TEL 5012
INTERNET:	2 X STARLINK MARITIME
GSM 4G/5G:	PEPWAVE

INTERNET PACKAGE

STARLINK MARITIME	50-100 MBPS
VSAT	MIR 8 MBPS CIR 2 MBPS

STARLINK WILL NOT BE PROVIDED IN AREAS WHERE THERE IS NO STARLINK COVERAGE.

COMMUNICATION PACKAGE IS INCLUDED IN THE CHARTER FEE AND WILL NOT BE CHARGED ON THE APA.

ON REQUEST:

THE COST TO UPGRADE TO A HIGHER VSAT SPEED IS ON THE CLIENT'S ACCOUNT.

A luxury yacht is shown on the water at dusk. The yacht is dark with some highlights on its upper decks. In the background, there are mountains under a dark sky. The overall scene is dimly lit, with a blue and purple color palette.

CHARTER RATES

2024 CHARTER RATES

HIGH SEASON
JULY AND AUGUST

€1,400,000

PER WEEK

PLUS VAT, PLUS COSTS (APA 30%)

LOW SEASON
ALL OTHER MONTHS

€1,200,000

PER WEEK

PLUS VAT, PLUS COSTS (APA 30%)

EVENTS

€1,400,000

PER WEEK

PLUS VAT, PLUS COSTS (APA 30%)

A Security Deposit of €100,000 applicable to all charters



**LARGE
YACHT
CORP.**

FOR INQUIRIES & MORE INFORMATION

VESA KAUKONEN

vesa@largeyachtcorp.com

+33 643 915 414

OFFICES

25 Boulevard Albert 1er,
98000 Monaco

Douglas Chambers,
North Quay Douglas,
IM1 4LA Isle of Man

www.largeyachtcorp.com